

GENERAL NOTES:

1. THE CONTRACTOR SHALL BE RESPONSIBLE FOR ALL LINE AND GRADE STAKES.
2. UTILITIES ARE LOCATED ON THE DRAWINGS BASED UPON AVAILABLE INFORMATION. THE NUMBER AND LOCATION OF UTILITIES SHOWN ARE APPROXIMATE. THE CONTRACTOR SHALL NOTIFY ALL UTILITY COMPANIES FOR THE LOCATION OF ALL UTILITY SERVICES PRIOR TO BEGINNING ANY EXCAVATION OR CONSTRUCTION, AND SHALL BE RESPONSIBLE FOR THE EXACT LOCATION AND PRESERVATION OF ALL BURIED UTILITY LINES.
3. THE CONTRACTOR, AT HIS OWN EXPENSE, SHALL REMOVE, PRESERVE, AND RESET ALL FENCES, POSTS, CULVERTS, SIGNS, STREET MARKERS, MAILBOXES, AND THE LIKE WITHIN THE LIMITS OF THE PROPOSED IMPROVEMENTS.
4. ALL CONSTRUCTION AND EXCAVATION ACTIVITIES SHALL BE CONFINED TO EASEMENTS, ROAD RIGHT-OF-WAYS, AND/OR WORK AREA LIMITS AS SHOWN ON DRAWINGS.
5. ALL TRAFFICWAYS, INCLUDING DRIVEWAYS, ALLEYS, ETC., SHALL REMAIN ACCESSIBLE TO RESIDENTIAL AND EMERGENCY VEHICLES THROUGHOUT PROJECT DURATION.
6. ALL CONSTRUCTION ACTIVITIES SHALL BE IN ACCORDANCE WITH THE CITY OF MONETT STANDARD SPECIFICATIONS.
7. ALL TRENCHES UNDER DRIVES AND STREETS MUST BE BACKFILLED WITH GRANULAR BACKFILL AND COMPACTED TO 95% STANDARD DENSITY.
8. ALL AREAS DISTURBED BY CONSTRUCTION, NOT PAVED, SHALL BE TOPSOILED, FINISH GRADED, SEEDED, AND MULCHED.
9. ALL MANHOLE FRAMES AND COVERS, WATER AND GAS VALVE BOXES AND LIDS, ETC. SHALL BE SET OR ADJUSTED TO MATCH FINISHED GRADE ELEVATION AND SLOPE.
10. THE CITY OF MONETT STANDARD SEWER SPECIFICATIONS MAY BE REVIEWED ON THE CITY WEBSITE, UNDER DEPARTMENTS, UTILITIES, WATER DEPARTMENT, CONSTRUCTION SPECIFICATIONS-SEWER.
11. SEWER SERVICE RECONNECTIONS SHALL BE REPLACED FROM NEW SEWER LINE TO EXISTING RW. REPLACEMENT SERVICE SHALL BE SCH 40 PVC PLACED AT 2.5% MIN SLOPE OR APPROVED. CLEAN OUTS SHALL BE PLACED AT ALL HORIZONTAL OR CHANGE IN GRADE BENDS. RECONNECTIONS SHALL BE COORDINATED WITH AFFECTED PROPERTY OWNER PRIOR TO INSTALLATION.

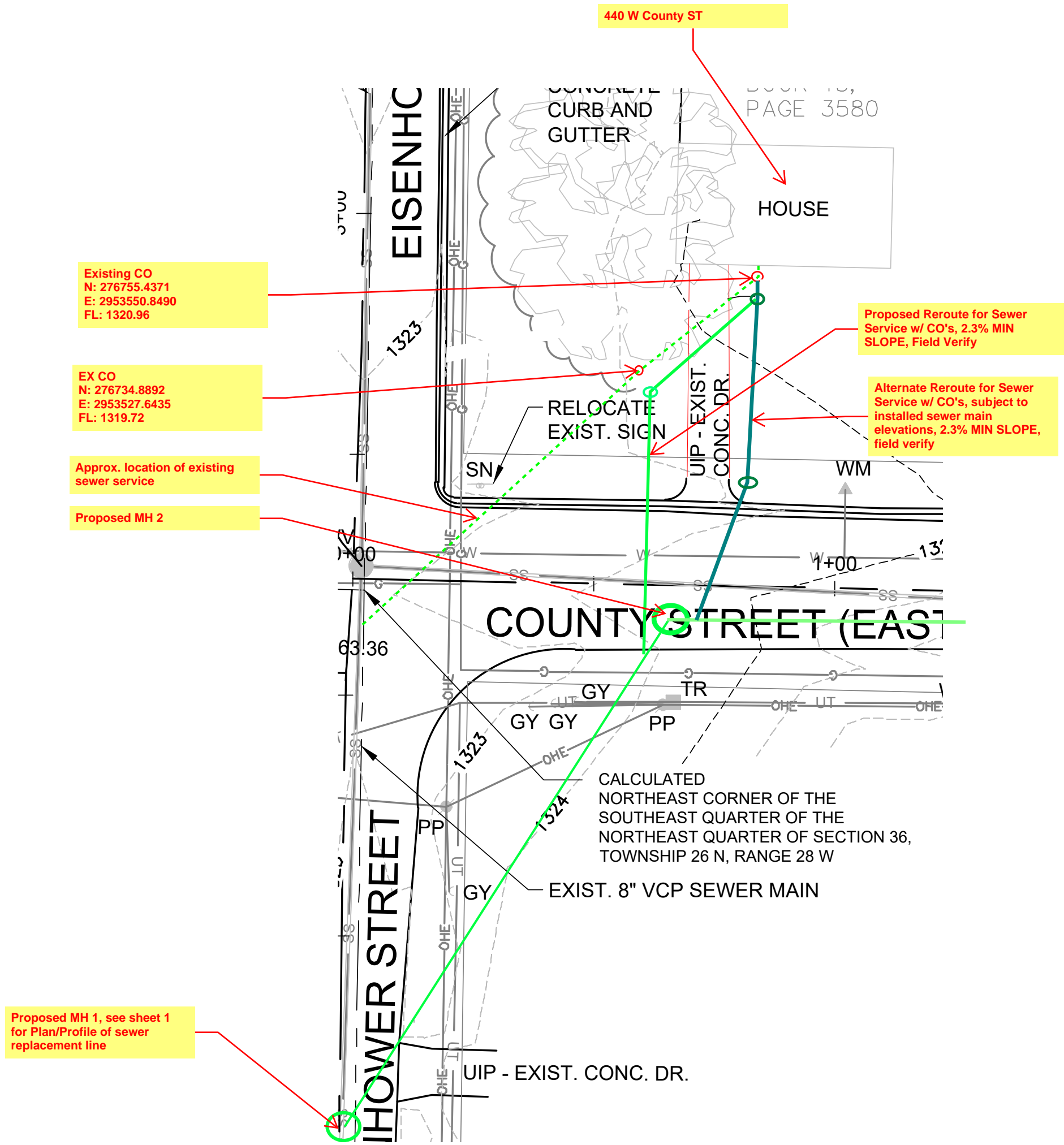

CALL OR CLICK 3 DAYS BEFORE YOU DIG!
1-800-DIG-RITE OR 811
MISSOURI ONE CALL SYSTEM
www.mo1call.com

NOTE: INFORMATION SHOWN ON PROJECT DRAWINGS CONCERNING LOCATION OF UNDERGROUND AND OTHER UTILITIES IS SHOWN FOR REFERENCE AND NOT GUARANTEED TO BE ACCURATE OR ALL INCLUSIVE. THE CONTRACTOR IS RESPONSIBLE FOR PRESERVING AND PROTECTING EXISTING UNDERGROUND AND OTHER UTILITIES AS NECESSARY TO AVOID DAMAGE.

SES

SPRENKLE ENGINEERING SERVICES
5704 Lawrence 2220, Pierce City, Missouri
WWW.SPRENKLE.COM

DATE:	xx	DATE	REVISION
DRAWN BY:	xx		
CHKD. BY:	KRS		
JOB NO.:	xx		

LOCATION MAP, DETAILS AND NOTES
COUNTY STREET SEWER REPLACEMENT

MONETT, MISSOURI

DWG. NO.

CVR

of

X

MO COA 2021000417



02/22/2022